

Whitecroft Road, Sheldon



Contact us for more information 0121 750 0390





## Directions



KLARICO estate agents proudly present this stunning 3 bedroom semi-detached property located within a prominent part of Birmingham. Benefits from having an impressive rear garden and provides off road parking for multiple vehicles. Provides Spacious out building. Book you're viewing now to avoid disappointment!

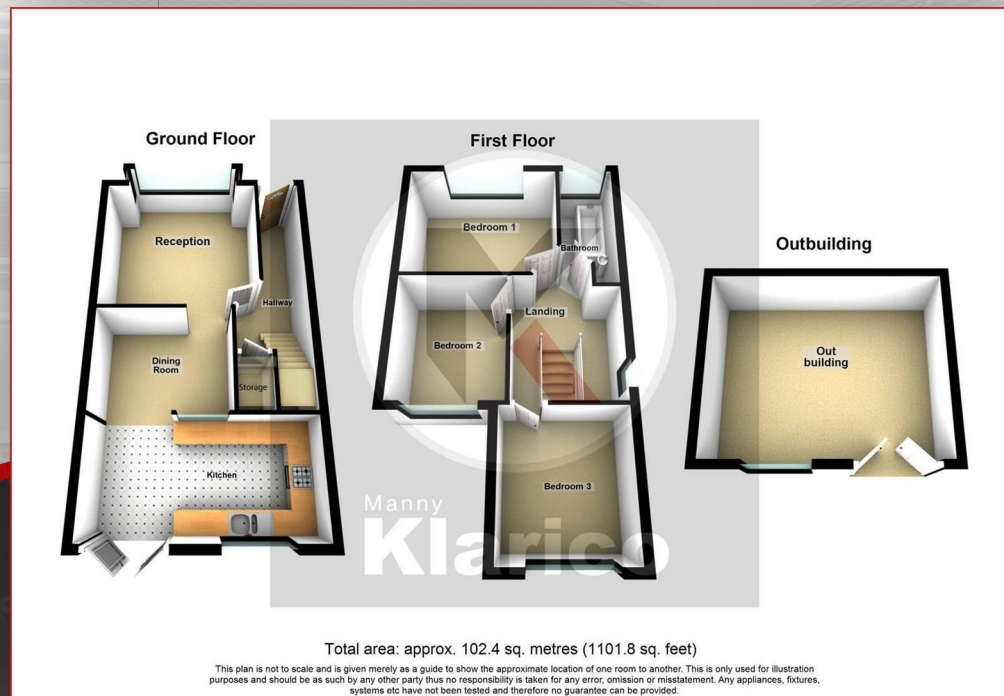

**Reception**  
3.52m x 3.87m (11'7" x 12'8")

**Dining Room**  
2.44m x 3.18m (8'0" x 10'5")

**Kitchen**  
2.50m x 5.00m (8'2" x 16'5")

**Landing**

**Bedroom 1**  
2.92m x 3.61m (9'7" x 11'10")

**Bedroom 2**  
2.93m x 2.46m (9'7" x 8'1")

**Bedroom 3**  
2.97m x 2.76m (9'9" x 9'1")

**Bathroom**  
3.20m x 1.29m (10'6" x 4'3")

**Out building**  
4.00m x 5.00m (13'1" x 16'5")

**Garden**